

BP14.R006

CONTRACT: DN00586

See Sheet 1A For Index of Sheets  
See Sheet 1B For Conventional Plan Sheet Symbols

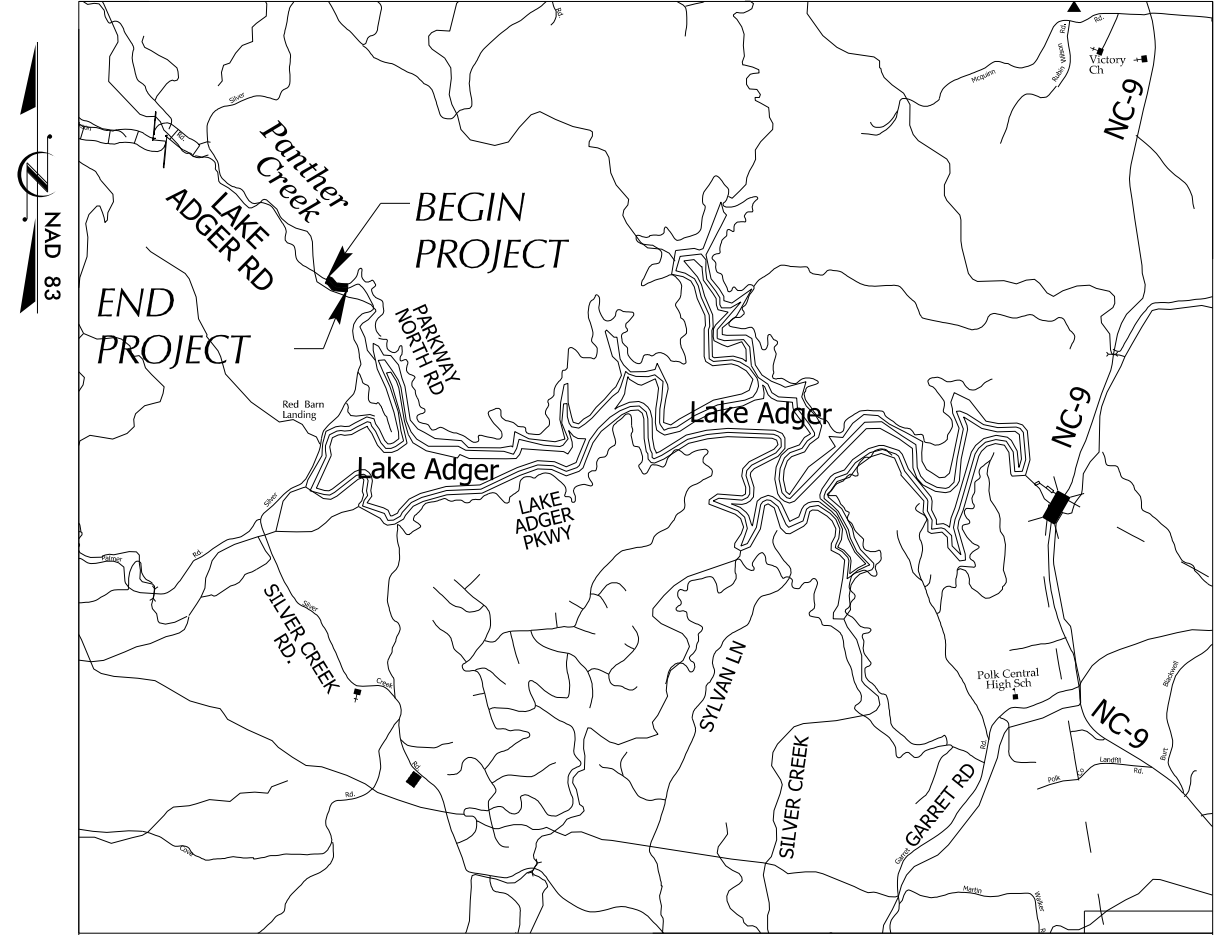

VICINITY MAP

STATE OF NORTH CAROLINA  
DIVISION OF HIGHWAYS

POLK COUNTY

LOCATION: REPLACE POLK BRIDGE 740143 ON SR 1138 OVER PANTHER CREEK

TYPE OF WORK: GRADING, DRAINAGE, PAVING, RETAINING WALL, AND STRUCTURE



NAD 83

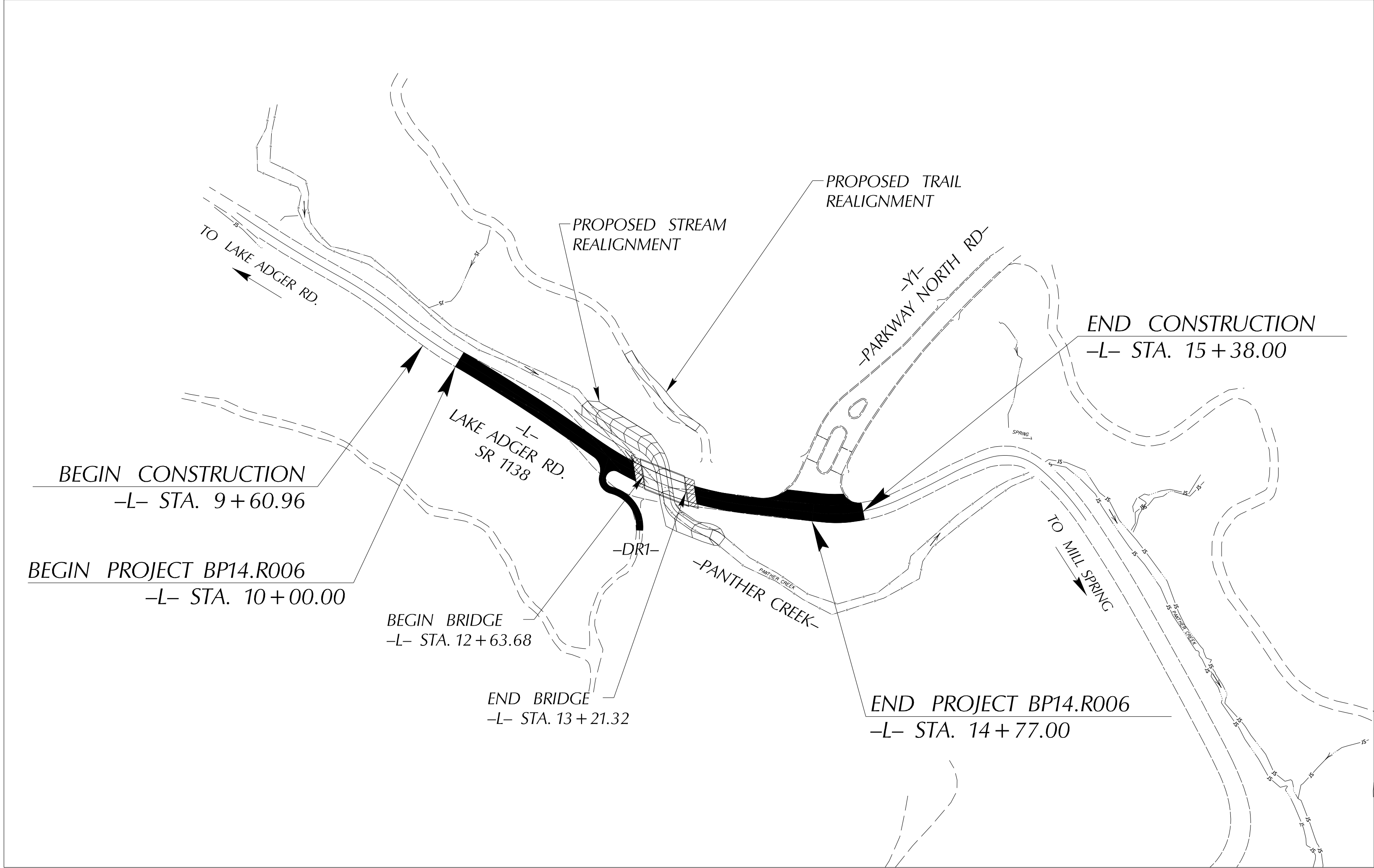

STRUCTURES

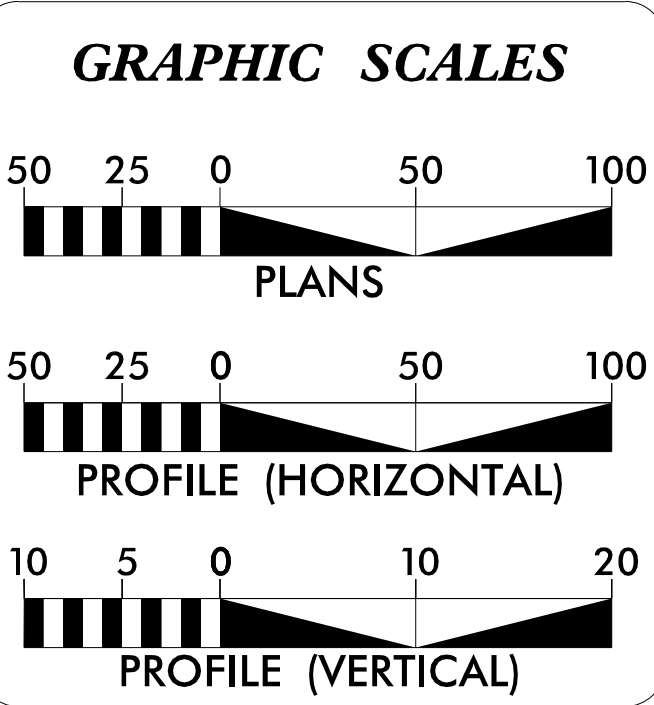

DESIGN DATA	
ADT 2025 =	N/A
ADT 2045 =	< 400
K =	12 %
D =	55 %
T =	13 % *
V =	20 MPH
* TTST =	1% DUAL 12%
FUNC CLASS =	LOCAL
SUB-REGIONAL	

PROJECT LENGTH

LENGTH ROADWAY TIP PROJECT BP14.R006 .....	0.080 Miles
LENGTH STRUCTURE TIP PROJECT BP14.R006 .....	0.010 Miles
TOTAL LENGTH TIP PROJECT BP14.R006 .....	0.090 Miles

Prepared in the Office of:

**NIV5**

NIV5 ENGINEERS & CONSULTANTS, INC.  
3300 REGENCY PARKWAY, SUITE 100  
CARY, NC 27513  
P: 919.851.1912  
www.NIV5.com  
NC License # F-5333

FOR THE NORTH CAROLINA DEPT. OF TRANSPORTATION

2024 STANDARD SPECIFICATIONS

RIGHT OF WAY DATE:  
OCTOBER 19, 2023

LETTING DATE:  
DECEMBER 09, 2025

NCDOT CONTACT:

ROBERT C. LARSON, P.E.  
PROJECT ENGINEER

JACOB M. DAVIS, P.E.  
PROJECT DESIGN ENGINEER

ANDREW BUCHANAN  
DIVISION 14 PROJECT MANAGER

DOCUMENT NOT CONSIDERED FINAL  
UNLESS ALL SIGNATURES COMPLETED

